

Celebrating 75 Years



1930-2005

LEADERSHIP. PARTNERSHIP. SERVICE.



2003-2004. What a year it was! Positioning the League for the 20th annual A Shopping SPREE, the League's 75th Anniversary, the 2005 Governor's Inaugural Ball and an upcoming capital endeavor was no easy task... but hands down — we did it!

The 2003-2004 Board and Leadership Council worked hard to identify how the League could continue its legacy of community impact and excellence during such a busy year ahead for 2004-2005. I am proud to say that not only did our existing community projects flourish (more about our community impact on the following pages), but the organization itself prospered and grew and is poised for the year ahead. Here's just a small sampling of how:

- 2003-2004 saw our membership base continue to expand, with record numbers of women seeking to join our mission.
- Emphasis was placed on building member connections—realizing that when members feel supported and appreciated, they in turn support the organization.
- A mid-year member survey recorded strong satisfaction by our members with their league association and this was underscored by their record increase in annual fund giving of over 40%.
- We adopted a new logo and tagline (see above) to compliment our 75 years of trained volunteerism, leadership and community service;
- We produced an interactive CD-rom sharing the League's 75 year history— promoting our rich heritage and was well as our strategic future.
- Our monthly magazine and website were overhauled and an electronic communication piece was introduced—all to rave reviews and to reflect the many facets we now offer to our members and to the public.

Again, these are just a few of the success stories from our League this past year. You played a role in this success, as you have been there every step of the way as we have lead, we have partnered and we have served. Thank you.

SUSAN FETZER VICK

President, 2003 - 2004



HUGE STRIDES FOR OUR SIGNATURE COMMUNITY PROJECTS IN 2003 – 2004

Leadership, Partnership, Service

Each year the League targets its volunteer and financial resources to a single and compelling community target need: Promising Youth: Changing Lives Through the Power of Education. In addition to the dynamic community teams the League deploys each year, we also fund and support large-scale projects that benefit this target area. 2003-2004 saw exciting results from our intensive efforts with our signature Heritage Park Community Learning Center and the Natural Learning Initiative.

Heritage Park

This collaboration has been nothing short of a tremendous success. Period.

Since its adoption of the Heritage Park Community Learning Center two years ago, the Junior League of Raleigh's investment of \$300,000 has clearly bolstered the on-site computer lab, library, preschool and the expansion of other existing resources at Heritage Park Public Housing Community. But the Junior League has helped Heritage in another and very substantial way. A special feature of our sponsorship of the Heritage Park Learning Center has been the regular deployment of a dedicated team of Junior League volunteers who work with the resident children and other community collaborators on various weekly enrichment and educational programs. As a result of our hands on involvement at Heritage, the children living in this public housing community now have a full-scale after-school educational support system and their corresponding success has been dramatic.

In just our second full year of volunteering at Heritage, there have been some exceptional strides made by the children participating in the learning center's programming. As opposed to just a few years ago, the statistics now include:

- > 91% of elementary students passing their End-of-Grade tests last year;
- > 81% of middle school students passing their End-of-Grade tests last year;
- > 73% of students increasing at least one letter grade in one or more core subjects in the last quarter alone;
- > Participation of middle and high school students in the learning center's programs increasing by 50%
- > Overall enrollment in the centers programming increasing by 40%

Just a few of the programs initiated by the League that have brought about this success story are: the Bug Club, an esteem-building program that celebrates good report cards; introduction of a Heritage Park Girl Scout troop; collaboration with the Project Enlightenment On The Road To Reading program; initiation of an interactive Book Club; sponsorship of a Community Health and Family Fun

Day; and hosting of the Fall Festival and the Heritage Park Shopping Spree.

The League is proud of the children of Heritage Park and proud of the results that strong partnerships and dedicated service can bring about.

Natural Learning Initiative

In conjunction with its sponsorship of the Heritage Park Community Learning Center, the League diagnosed another community need facing the children living at Heritage and across our community: the lack of stimulating outdoor and creative learning space. While the League's learning center addressed "inside learning" and afterschool academic support, the League quickly saw what little opportunity children at Heritage had to learn through imagination, exploration and socialization — which comes from "outside learning." It is this type of learning which experts say is crucial for the academic and social success of a child. The League decided to tackle that.

And tackle it they did.

The first phase of this stimulating, outdoor learning facility is complete. Transforming a wet, swampy lowland at the back of the Heritage Park Public Housing Community was no easy task. But today, with Phase One complete, there is now an inviting, fertile field— full of pathways, bike trails and exploration areas to entice children to imagine and explore. With help from NCSU and other community partners who have collaborated with our Junior League NLI team, this natural learning facility is "on the ground" and ready for action.

Next comes the vegetable garden, outdoor theatre stage, benches, forts and other amenities that beckon children and the creative play that positively parlays into classroom performance and overall character enhancement.

This NLI is a wonderful gift to our promising youth and our entire community!

We are leaders; we are partners; and we serve our community.

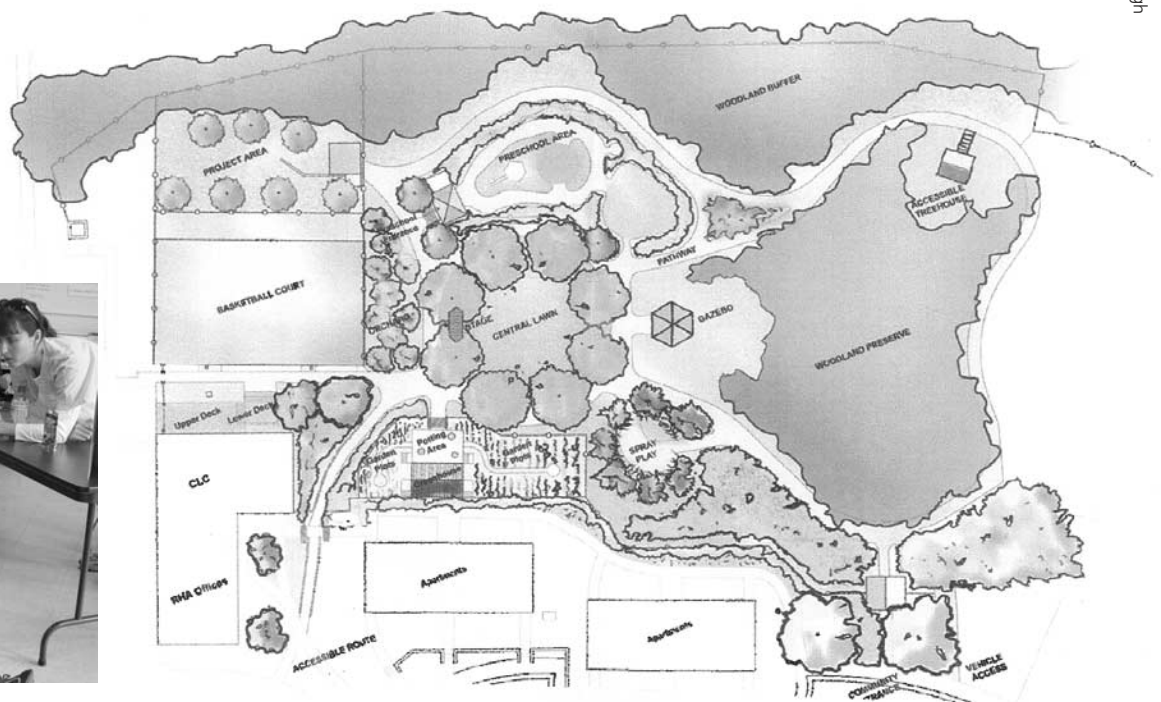



Financial Position for the year ended May 31, 2004

	UNRESTRICTED	TEMPORARILY RESTRICTED	TOTAL
REVENUE			
Membership dues and fees	\$ 183,608	\$ -	\$ 183,608
Bargain Box sales and donated goods	834,972	-	834,972
"A Shopping Spree"	605,804	-	605,804
Fund for the Future	-	-	-
Community Fund	93,504	-	93,504
Cookbook	39,081	-	39,081
Capital campaign	-	275,057	275,057
Natural Learning Initiative	-	2,290	2,290
Investment income	22,434	-	22,434
Gain (loss) on sales of investments	7,121	-	7,121
Unrealized gain on investments	19,445	-	19,445
Other revenue	8,106	-	8,106
TOTAL REVENUE	1,814,075	277,347	2,091,422
Net assets released from restrictions	30,663	(30,663)	-
Total revenue after releases from restrictions	1,844,738	246,684	2,091,422
EXPENSES			
Programs and services			
Projects and programs	327,223	-	327,223
Bargain Box	678,720	-	678,720
"A Shopping Spree"	365,524	-	365,524
Fund for the Future	5,180	-	5,180
Cookbook	25,323	-	25,323
Capital campaign	1,641	-	1,641
Natural Learning Initiative	23,842	-	23,842
Total programs and services	1,427,453	-	1,427,453
Support services	373,520	-	373,520
TOTAL EXPENSES	1,800,973	-	1,800,973
Change in net assets	43,765	246,684	290,449
Transfers	(25,000)	25,000	-
Net assets - beginning of year	1,235,409	91,525	1,326,934
Net assets - end of year	\$1,254,174	\$363,209	\$1,617,383

The Junior League of Raleigh's financial statements are audited annually. The condensed financial statements presented below are derived from the 2003-2004 audited financial statements prepared by the firm of Boyce, Furr & Company, LLP. A complete copy of such financial statements and auditor's report may be obtained at League headquarters located at 4020 Barrett Drive, Suite 104 in Raleigh or by calling 919-787-7480. In addition, ongoing planning and monitoring of Junior League of Raleigh's income and expenditures are conducted by several in-League volunteer entities. The League's Finance Committee is responsible for advising the Board of Directors and leadership councils on financial matters, assisting in the preparation of the annual budget, examining budgets of proposed projects, reviewing the League's investment portfolio, and reviewing and approving the various reserved funds. Finance Committee members are also designated as liaisons to each Junior League of Raleigh committee. As liaisons, these Finance volunteers serve as information resources on financial matters, assisting committee Chairs in understanding their current year budgets and developing a budget for the next fiscal year. These efforts help assure sound financial management and adherence to the Junior League of Raleigh's fiscal and community service strategies.

project funding & grants awarded in 2003-2004

Communities in Schools of Wake County

Heritage Park Community Learning Center
\$50,000

House of Hope of NC

Outpatient Program expansion
\$4,500

The Arc of Wake County

"Project SEE"
\$8,500

Sisters of Faith Empowerment Ministry

What about the Children/ Life is a Dance
\$8,500

The North Carolina Theatre

NCT Kids on Broadway
\$5,500

Jr. Achievement of Eastern NC

Economics of Staying in School)
\$5,500

Prevent Blindness, NC

Public School Screenings in Wake County
\$8,500

The Salvation Army & The Raleigh Rescue Mission

Bridge of Hope
\$5,500

Growing Together Preschool

\$8,000

StepUp Ministry

StepUp Children's Ministry Initiative
\$8,500

Prevent Child Abuse NC

Prevent Child Abuse Training Institutes
\$6,500

SAFEchild

Motheread/Fatheread
\$5,500

THE 2003-2004 LEAGUE LEADERSHIP TEAM

BOARD OF DIRECTORS

Susan Vick
President

Susan McAllister
President-Elect

Beth Graves
Community Vice President

Bari Jo Davis
Funding Vice President

Susan Bowers
Membership Vice President

Danita Morgan
Planning Vice President

Marla Turlington
Training & Communications Vice President

Molly Benson
Nominating Chair

Wynn Bettinsoli
Secretary

Suzanne Brooks
Treasurer

COMMUNITY COUNCIL

Dori Pyles
Community Funding

Katherine Anne Hamlin
CRPD

Amy Watkins
Placement Assist

Melissa Matton
Public Affairs

Leigh Ann Watson
Secretary

FUNDING COUNCIL

Lisa Vanderberry
Bargain Box

Susan Stevens
Cookbook Co-Chair

Becky Hemmig
Cookbook Co-Chair

Lisa Ham
Annual Fund

Anne Allen
SPREE! Co-Chair

Nancy Bromhal
SPREE! Co-Chair

Anne Godwin
Secretary

Shannon Roley
Treasurer-Elect

MEMBERSHIP COUNCIL

Anne Rogers
Arrangements Co-Chair

Michelle Whichard
Arrangements Co-Chair

Maria Dameron
Member-at-Large

Patti Benedict
Membership Development

Paige Van Lenten
Placement

Jane Hunt
Sustainer Chair

Emily Parrott
Transfer Chair

Amy Watson
Secretary

PLANNING

COUNCIL

Rhonda Clark McNairy
Advisory Planning

Linda Douglas
Inaugural Ball Co-Chair

Graham Satsky
Inaugural Ball Co-Chair

Wendy Webster
Nominating Assistant

Megg Rader
Past President

Kim Peele
Project Guide

Julie Hardesty
SPREE! Assistant Co-Chair

Mollie Owen
SPREE! Assistant Co-Chair

Heather Thompson
SPREE! Assistant Co-Chair

TRAINING & COMMUNICATIONS COUNCIL

Alicia Morris
Arrangements Assistant Co-Chair

Britt Thomas
Arrangements Assistant Co-Chair

Lori Fuller Niver
theLINK Editor

Michele Roach
Provisional Chair

Lisa Marie Ferrell
Public Relations Chair

Kati Mullan
Training Chair

Caroline Russell
Secretary

COMMUNITY TEAM CAPTAINS

Alston Glass
Heritage Park

Meredith Blanton
Heritage Park

Susan Stephens
Helping Horse

Winnie Bolton
Chorus

Pat Wilkins
Guardian Ad Litem

Courtney Bolen
Girls on the Run

Richelle Sajovec
Girls on the Run

Jenny Harrell
Natural Learning Initiative

Mollie Hodl
Quick Impact

Elizabeth Robbins
Quick Impact

Amy Marshburn
SAFEchild

Susan Sheffield
SAFEchild

Harriett Stephenson
Step Up Ministries

Keri Pharr
Team Y

Michelle Cofield
TCOB

Selene Brent
TCOB

COMMUNITY ADVISORY BOARD

Anna Neal Blanchard
The Steward's Fund

Beth Briggs
Creative Philanthropy

Ralph Capps
Boys & Girls Clubs

Marty Clayton
Progress Energy

Barbara Curtis
Curtis Media Group

Bobbie Furr
Boyce, Furr & Company LLP

Robbie Graham
Hope Elementary School

Cecil Harrison
Poyner & Spruill

Margie Johnson
Community Volunteer

Bill Massey
r+m Creative

Bill McNeal
Wake County Public School System

Marjorie Menestres
SAFEchild

Albert Moore
Christ Episcopal Church

Anne Sherman
Project Enlightenment

David Weaver
BB&T

Colon Willoughby
Wake County District Attorney

Carter Worthy

Carter Worthy
Commercial Real Estate

Mary Brent Wright
Community Volunteer

Kay Yow
Head Coacg
NCSU Women's Basketball

HEADQUARTERS STAFF

Susan Stanhope
Administrative Director

Melanie Rankin
Development Director

Joe Wallach
Staff Accountant

Terri Ferraro
Membership Records

Rosa Frivance
Computer/Administrative Services

Lori Woods
Administrative Assistant

BARGAIN BOX STAFF

Judy Adams
Manager

Charles Terry
Assistant Manager

Corey Martin
Assistant Manager

Jessica Tugwell
Sales Associate

Nancy Hight
Sales Associate

Steven Pearce
Sales Associate

corporate and community sponsors

GRAND BENEFACTOR

ABC 11
Chick-fil-A
Time Warner Cable
WakeMed
WRAL-FM/MIX 101.5

BENEFACTOR

Bailey's Fine Jewelry
Carrabba's Italian Grill
Lassiter Mill Gardens
Progress Energy Carolinas
The Hamlin Companies

ADVOCATE

Bank of America
First Citizens Bank
Foster's American Grill
Goodfella's Old World Brick Oven Pizza
Kelly Odom Flowers/Interiors
Sprint
The News & Observer
WRSN Sunny 93.9

SUPPORTER

Alfred Williams and Company
Branch Banking and Trust Company
Burnie Batchelor Studio, Inc
Capital Creations Gourmet Pizza
Carolina Mudcats Baseball
Cherokee Investment Partners
Kerr Cares for Kids Foundation
Ri Ra, The Irish Pub
Stonewood Tavern & Grill
TLC Laser Eye Centers
Unforgettable Food Affairs
Wachovia Corporation
York Properties/York Simpson & Underwood

SPONSOR

Blue Water Spa
Carolina Hurricanes
Carolina Wine Company
CarQuest-General Parts, Inc.
Custom Brick Company, Inc
Deloitte and Touche LLP
Delta Dawn Charter, Inc.
GlaxoSmithKline, Inc
Golden Corral Charitable Fund of the
Triangle Community Foundation
Joyce Fitzpatrick
Kati Mullan
Kennedy Office Supply Co
Michelle Snead Portraits

North Carolina Pork Council Inc
North Carolina Press Services
Pet & People Portraits
Portrait Brokers of America
The Char-Grill Companies
US Foodservice
WTRG 100.7 FM
YMCA Partners
Wake Stone Corp.
Winn Dixie

PATRON

Acro Cafe & Catering
All Carolina Crane
Barbara Boney Caters
Bob Hughes Associates Inc.
California Pizza Kitchen
Cameron Clothing Company
Capel Rug Outlet
Capital City Club
Cary Skin Center
Catering Works, Inc.
Central Carolina Bank & Trust
Chair & Equipment Rental Co
Christopher Lewis White, PA
Garland C Norris Co
GE Mortgage Insurance Corporation
Harris Wholesale, Inc
Jim and Stephanie Conrad
Julia Jones Daniels
Kane Realty Corporation
Larry's Coffee Beans, Inc.
Law Offices of George W. Lennon
Learning Express
Little, Menefee B
Michael Law, MD, PA
Mike Hoyt
Missy McLamb Photographers
Moore & Johnson Agency
Mutual Distributing Company
Pipes by George
Raleigh Racquet Club, Inc
She She me, Inc.
Small Kane Architects
Smedes and Rosemary York
Southwest Airlines
Whitnee's Antiques
Womack Family Properties
Wyrick Yates Robbins & Ponton

FRIEND

42nd St Oyster Bar
Alesandra Price
Amadeus & Company

Amanda Rossi
Amedeo's Italian Restaurant
Angus Barn
Balentines Catering Company
Beth Smith
Suzi Bevacqua
Big Ed's Restaurant
Big Sky Bread Company
Biscuitville, Inc
Body Balance Therapy, LLC
Brier Creek Country Club
Brier Creek Country Club
Caffe Luna
Cardinal Club
Carlisle by Smith-Leforte
Carolina Ballet
Caroline H. Russell
Catherine Feldman Designs/Ooh la la
Cherchies Ltd
CMI
Cotton Colors
Cravings, A Maternity Boutique
CVS Pharmacy
Danita Morgan and Chris White
dilly dally
Divine Collections
Douglas Carroll Salons
Down Under Surf & Scuba
e.r.l. Originals
Ellen Garrett
Ellie Lance Creations
Fabulous Pewterware
Flour Shop, Inc
Fountainhead Building & Realty
Friends of the NC State Museum of Natural
Sciences
George R. McNeill, II Fine Antiques and
Interiors
Grape Expectations Wine Imports, Inc
Great Outdoor Provision Company
Greater Raleigh Refrigeration, Inc
Hands on Health
Harris Teeter, Inc
Hunter & Lords
latridis Design
It's Five O'clock Somewhere Supper Club
J & M Marketing
JC Designs
Jeff Gordon Foundation
JellyBeans Super Skate Center
Just For Me
Kaboodles
Kellie Lewis
Kid Time

Kipp, Sandra Darcy
Kristi Ward
LadyFingers
Lassiter Mill Gardens
Laura English Photography
Learning Express
Lemanowicz, Nanci Faith
Maggie Moo's Ice Cream and
Treatery
Metta Unlimited
Mitchell's Catering and Events
Mobley's Framing & Gallery
Molly Smith Anderson
Montgomery's Florist
My Charmed Life
My Gym
Nancy's Vera Bradley
NC Museum of Art
NCSU Athletics
NCSU Athletics
Nicole's Studio
NoFo at the Pig
North Carolina Museum of
History Associates
North Carolina Pork Council Inc
North Carolina Symphony
N-Shape Personal Fitness
O2 Fitness
Pam Shank
Patti Benedict
Patsy Aiken Designs
Peche de Chocolat
Perry's Gun Shop
PLAYSPACE Children's Museum
Pleasant Company
Powell, Nikki P. Michelle
Prestonwood Country Club
Prestonwood Country Club
Pretzer, Katherine Salisbury
Private Collection
Quintessentials
Raleigh Little Theater
RKR B, Inc.
Robert L. Williamson, III, DDS,PA
Rocky Top Hospitality
S. Burke, Inc.
Sally Plyler Designs
SAS Championship
Scout & Molly's
Second Empire Restaurant &
Tavern
Senator John Edwards
Shoe String Studio
Smart Body Pilates

Stock Building Supply
Tammy's Fine Papers & Gifts
Tassels, Inc
The Frog Patch
The Hotel Group, Inc
The Museum Spa
The NC Theatre
The Original Italian Pie
The Other Woman, Inc.
The Peanut Patch
The/Lazy Rug
The/North Carolina Theatre
Theatre in the Park
Tom James Co.
Tookie's Six Forks Deli
Tookie's Toys
Tripp Avery Handbags
Vietri
Vineyard Vines
VIP Exclusives
Wagoner's Christmas Trees
Wardrobe Consulting
Water Water Everywhere
White Interiors

BARGAIN BOX

Anonymous
Books at Stonehenge
Charlotte's
Children's Orchard
Furnishing Solutions
Garden Gate Cottage
Kathleen Lowry
Stein Mart
Swagger
The Kat's Meow
The Shade Tree, Inc.
Wide Shoe Warehouse
www.nearlynewclothingexchange.com

COMMUNITY TEAM

PROJECTS

Adrienne Vittadini
Bailey's Fine Jewelry
Theresa Clark
Hal Eddins
IBM
Food Lion at Lake Boone
Fresh Market, Cary
Elizabeth Gooding, RN
Harris Teeter, Glenwood Village
Harris Teeter, Six Forks Road

Johnson-Lambe Company
Jim Price
Jaimie Nicole Samelko
Scrapbook Plaza
Staples
Heather Tanza
Time Warner Cable
Wachovia Bank
Wake Up for Children
Wal-Mart

COOKBOOK

Fallons Florist
Fresh Market, Cameron Village

GENERAL NEEDS

Apple Gold Group
Burt's Bees
Carolina Wine Company
Cici's Pizza
Amy Jo Bain Horne
Inner Self
Morningstar Mini-Storage
Mary Moss
Poyner & Spruill
Training by Design
VIN Restaurant & Wine Bar
Elaine Moyer Whitford

PROVISIONAL

PROJECTS

535th Military Police Battalion
Adventure Landing
Alice Aycock Poe Center for
Health Education
Alpha Chi Sigma at NCSU
Amward Homes, Inc.
Applebee's
Avent Ferry Florist
Barnes & Noble, Brier Creek
Baskin Robbins
Be Active NC
Best Buy #299
Blockbuster
Bullard Restaurants
Capital Creations Gourmet Pizza
Capital Events
Carmike Cinemas, Inc.
Carolina Canines for Service, Inc.
Carolina Donor Services
Chair & Equipment Rental Co.
Cici's Pizza
Doctors Vision Center
Domino's Pizza Cary

Dunkin Donuts
Eckerd Drugs
Fat Daddy's Market & Grill
Food Lion, LLC
Foster's American Grill
Golden Tough Carpets
Good Times Catering
Goodberry's Yogurt
Grand Rental Station
Harris Teeter, High House Road
Harris Teeter, Inc.
Hayes Barton Baptist Church
Healthy Mothers, Healthy Babies
Coalition of Wake County
Hillandale Golf Course
Jersey Mike's Subs
Jill Flink Studio
JPO Management Company
Kroger
Lowes Foods
McDonald's, Garner
Mellow Mushroom Pizza Bakers
NC Dept. of Transportation,
Office of Beautification
NC Operation Lifesaver, Inc.
Nursing Mothers of Raleigh
Panera Bread
Papa John's Pizza
Pfefferle & Kindrachuk
Pizza Hut
Planned Parenthood Health
Systems
Project DIRECT
RKR B, Inc.
RSVP Events, Inc.
Sam's Club
Smithfield Family Dentistry
Stock Building Supply
StormStudy
Strengthening
The Black Family, Inc.
Tar Heel Voices
The Women's Center, Inc.
Time Warner Cable
Velocity Motorsports
Wal-Mart
Winn Dixie

“we’re teaming with women....”



Each year the Junior League of Raleigh deploys over 600 volunteers through its annual placement system. The various placements available to our members fall within our mission of promoting voluntarism, developing the potential of women and improving communities through the effective action of trained volunteers. Several of these placement options include “community teams,” where our members can collaborate with other agencies working in our “Promising Youth” target area. The team approach allows our members to work in groups and offers flexible volunteer times to fit the scheduling needs of our membership. Our community teams include:

Bargain Box

A community favorite, the Junior League’s historic Bargain Box provides good quality clothing and household items to the community at a reduced price.

Community Learning Center

The Junior League conducts educational, enrichment and cultural activities for our promising youth in our very own Community Learning Center at Heritage Park.

Guardian Ad Litem

Junior League members train with and volunteer within the district court judicial system to help the needs of abused and neglected children petitioned into the court system.

Girls on the Run

Junior League members serve as role models and help young girls achieve a higher sense of self-esteem and learn about the benefits of being physically active.

Helping Horse

Disabled youth receive recreational therapy through the joy of horseback riding and with the volunteer assistance of Junior League members.

Kids on the Block

The Kids on the Block is an educational puppet program that enlightens children on the issues of disability awareness, medical-educational differences and social concerns. Team members rehearse and perform for area schools, preschools and for other promising youth programs.

Music

Junior League members sing a joyful noise with Chorus as they delight our community friends with the gift of song.

Natural Learning Initiative

Working with our young friends at the Heritage CLC and our design team, the Junior League is initiating the creation of a natural learning center – an outdoor educational and enrichment environment for the entire community.

Quick Impact

Junior League members will perform short, one-time services for community agencies needing temporary and immediate “womanpower” (preparing for upcoming projects, special events, drives, etc).

SAFEchild

A Junior League signature project, SAFEchild is committed to eliminating child abuse in Wake County by helping families create nurturing environments free from abuse and neglect.

Step-Up Ministry

Junior League members help provide positive social experiences for children while their parents attend Step-Up meetings at White Memorial Presbyterian Church.

Taking Care of Business

Junior League members share their skills and expertise by helping different community agencies promote their programs and mission through services including strategic planning, marketing and program expansion expertise.

Team Garner Road Y

Our volunteers work with after school children on a variety of personal enrichment and educational programs geared toward helping them succeed in school and in life.

2003–04 annual fund donors

COMMUNITY

LEADERS

Commercial Printing Company
Jay and Susan Vick

COMMUNITY

PARTNERS

Esther Hall
Julie Newcomb
Anne Ramsay
Beth & Steve Robinson
GlaxoSmithKline, Inc.

COMMUNITY

ADVOCATES

Ginger Jernigan
Danita Morgan
Virginia Parker
Melissa Peden
Gerald Thomas
Flo Winston

COMMUNITY

SUPPORTERS

Bell Family Foundation
Audrey Black
Anita Blomme
Blanche Bacon
Nell Barnes
Nikki Barresi
Patti Benedict
Molly Benson
Dorothea Bitler
Lee Black
Anna Neal Blanchard
Wendy Burkard
Francine Calogero
Karen Campbell
Carter Worthy Commercial Inc.
Marion Church
Gretchen Clifton
Lawrence & Sandra Davis Family
Foundation
Terri Dixon
Susan Easter
Jennifer Feinstein
Lisa Marie Ferrell
Alison Flaughner
Mary Susan Fulghum
Bobbie Furr
Beth Graves
Lisa Ham
Karen Harrison

Jennie Hayman
Alice Haywood
Betsy Henderson
Martha Howard
LaRinda Huntley-Kaplan
Dana Jennings
Margie Johnson
Tina Jones
Louise McCoy
Brooke McDaniel
Neill McLeod
Bill McNeal
Siobhan Millen
Julie Moore
Tyler Morris
Kati Mullan
Laura Pendleton
Dori Pyles
Anna Ragland
Melanie Rankin
Claire Renfrow
Michele Roach
Stagg Sanders
Lisa Sampair
Molly Shepherd
Leslie Silverstein
Eve Smith
Mary Stevenson
Gentry Summerlin
Mr. and Mrs. Brett Summey
Angela Sutton
Heather Thompson
Marian Troxler
Marla Turlington
Erdmuth Venable
Carol Wagoner
Leigh Ann Watson
Anna Webb
Lisa Williamson
Mary Brent Wright
Rosemary York

COMMUNITY

FRIENDS

Anna Absher
Taylor Aiken
Mary Ann Akin
Leslie Aldridge
Tricia Allen
Amy Allen
Anne Allen
Molly Anderson
Ashley Andrews
Nancy Andrews

Tay Appleyard
Hannah Baggett
Mary Baggett
Saunders Barnes
Rhonda Beatty
Laura Kay Berry
Wynn Bettinsoli
Martha Betts
Suzi Bevacqua
Carol Bilbro
Kathryn Bilbro
Leslie Bilbro
Eleanor Blackwell
Mary Blake
Courtney Bolen
Robin Bost
Mary Margaret Boulware
Susan Bowers
Michelle Boyette
Kim Brackett Jones
Becky Bradley
Nancy Brenneman
Selene Brent
Catherine Bridgers
Amy Brinley
Tricia Brody
Nancy Bromhal
Suzanne Brooks
June Brown
Laura Brown
Heather Buchanan
Virginia Bullock
Perrin Burton
Copie Cain
Francine Calogero
Caroline Carr
Carrie Carter
Jean Carter
Amy Challgren
Julie Clark
Christina Coffey
Gwynne Cook
Lillian Cotton
Nikki Corderman
Lisa Coston
Alyson Courington
Beth Covil
Martha Crampton
Rae Marie Czuhai
Sarah Dalonzo-Baker
Maria Dameron
Nancy Dameron
Bari Jo Davis
Ellen Davis

Cydney Davis-English
Debbie Day
Marion Deerhake
Cindy Densmore
Jennifer DeWolf
Jennifer Doerfler
Mona Donald
Nancy Doshier
Margaret Douglas
Mika Drew
Michelle Dunn
Ann Edmondson
Lennie Edwards
Tanya Eney
Lynn Eschenbacher
Margaret Faust
Tricia Fearing
Gina Flynn
Lucy Fountain
Susan Fountain
Carol Fowler
Sarah Fox
M. A. Fulford
Jill Gammon
Wendy Gantt
Linn Ginsler
Anne Godwin
Martha Goldfinch
Pam Gontram
Tricia Goodson
M.E. Grant
Jennie Greene
Anna Griffin
Emily Grimes
Paula Gupton Page
Carolyn Hall
Sharon Hall
Susanne Harer
Jenny Harrell
Peyton Hatfield
Angela Hatton
Cynthia Hemme
Pam Hemmelgarn
Becky Hemmig
Mollie Hodl
Anne Hogewood
Holy Trinity Evangelical Lutheran
Church
Susan Hornaday
Leslie Hubbard
Jane Hunt Worley
Susan Jasinski
Beth Jenkins
Mary Ann Jenkins

2003–04 annual fund donors

Stephanie Jenkins
Gloria Johnson
Suefan Johnson
Susan Johnson
Jennifer Jones
Lindsay Jones
Mary June Jones
Nanci Jordan
Shelly Kangas
Chancy Kapp
Caroline Kesler
Daisy King
Sandy Kipp
Kimberly Kiser
Tonya Koonce-Daniels
Susan Krause
Margaret Liles
Laurie Love
Margie Lucas
Katie Lyon
Greer Lysaght
Leigh Magee
Lyn Maness
Melanie Marshall-Park
Jane Martinez
Melissa Matton
Ashley May
Cindy Mazur
Susan McAllister
Paula McAnallen
Janice McDonald
Katherine McIntosh
Suzanne McKenzie
Sallie McOwen
Rachel Mersey
Helen Miller
Marilyn Miller-Fox
Susan Misenheimer
Megan Montgomery
Connie Moore
Dana Moore
Susan Moore
Frances Morisey
Meg Morton

Mary Moss
Sarah Mukerji
Kim Nabors
Lindsay Newsom
Lori Niver
Margaret Nordt
Linda Nunnallee
Shannon O'Dea
Mollie Owen
Jodi Palmer
Emily Parrott
Kim Peele
Laura Pendleton
Libby Perry
Keri Pharr
Dana Pias
Michelle Pilos
Sandy Poggi
Gena Poulos
Karen Prather
Cami Preti
Kathy Pretzer
Alessandra Price
Pamela Price
Lauren Pucillo Holmes
Suzanne Quirk
Megg Rader
Valerie Ramsey
Sharon Ravenscraft
Debbie Ray
Sherry Raymond
Wren Rehm
Catherine Rideout
Laura Ridgeway
Liz Riley
Julia Rivenbark
Anna Roberts
Amy Robinson
Lisa Roberts
Anne Rogers
Shannon Roley
Margaret Rolfsen
Karen Ross
Amanda Rossi

Kim Royal
Caroline Russell
Richelle Sajovec
Molly Sanders
Liz Sankey-Reilly
Graham Satisfy
Jenn Schick
Gail Scoggin
Susan Self
Cornelia Shaw
Beth Shore
Erika Small
Alicia Smith
Cleaves Smith
Diane Smith
LeGrande Smith
Kellie Sobocinski
Jennifer Sotir
Margie Springer
Liz Squires
Karlee Steele
Karin Stephens
Susan Stevens
Angie Stewart
Jane Stikeleather
Kathryn Stover
Brooke Summey
Dora Taylor
Susan Taylor
Tracy Teer
Melanie Tharrington
Evelyn Thiem
Britt Thomas
MaryBeth Thomas
Nancy Thompson
Tanya Thorson
Ann Tice
Maria Tierney
K.C. Trivette
Jeanne Turlington
Marla Turlington
Melanie Turner
Lisa Vanderberry
Lisa Van Genderen

Paige VanLenten
Whitney Von Haam
Jessica Wahler
Caroline Wall
Elizabeth Warren
Amy Watkins
Amy Watson
Stephanie Weatherspoon
MaryBeth Weber
Wendy Webster
Nancy Weddington
Idana Weiss
Kathryn West
Christine White
Janet White
Mary Kee White
Annie Wilkerson
Liz Wilkerson
Mary Lillie Wilkins
Barbara Williams
Mary Edna Williams
Melanie Williams
Susanne Williams
Lisa Williamson
Kate Wisz
Julie Wood
Julie Woodson
Sherry C. Worth
Betsy Wray
Jennifer Wray
Jacqueline Wynn
Melanie York
Parker York
Julia Young
Carolyn Younger
Maura Zarnik

MATCHING GIFTS

IBM (through Molly Benson,
Idana Weiss and Susan
McAllister)